

THREAD DETAIL INFORMATION: 6 THREADS PER INCH, 0.167 PITCH CONTINUOUS THREAD TO THE UNDERSIDE OF DECK			
REFERENCE	DIMENSION	TOLERANCE	UNITS
E	1.014 [25.76]	±0.007 [0.18]	in [mm]
T	1.108 [28.14]	±0.007 [0.18]	in [mm]
H "MAX"	0.699 [17.75]	±0.015 [0.38]	in [mm]
BOTTOM OD	1.232 [31.29]	±0.015 [0.38]	in [mm]
OAH	1.255 [31.88]	±0.015 [0.38]	in [mm]
PART WEIGHT	6.2	± 0.3	g
OPENING FORCE	5.0	± 3.0	lbf

**DISCLAIMER**

THIS INFORMATION IS PROVIDED AS A GENERAL GUIDE, INCLUDING DIMENSIONS. IT IS THE CUSTOMER'S RESPONSIBILITIES TO SELECT THE PROPER CONTAINER FOR PRODUCT AND APPLICATION COMPATIBILITY.

DISTRIBUTED BY:



REF NO.:

DWG31213

DESCRIPTION:

28-410 Silver PP Domed Gloss Disc Top, No Liner .330 Orifice

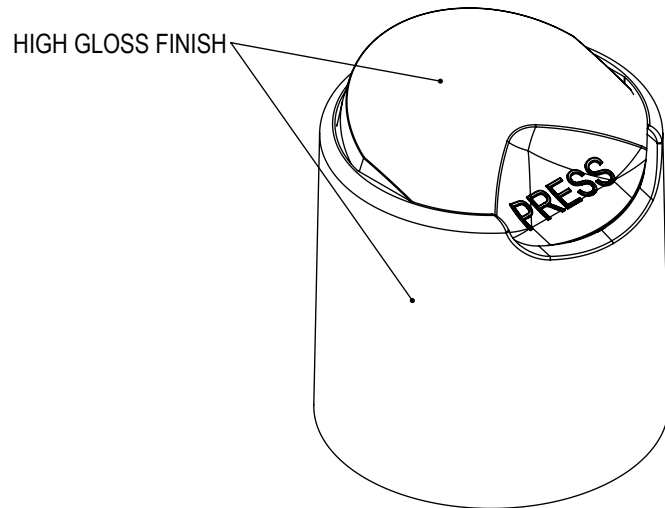
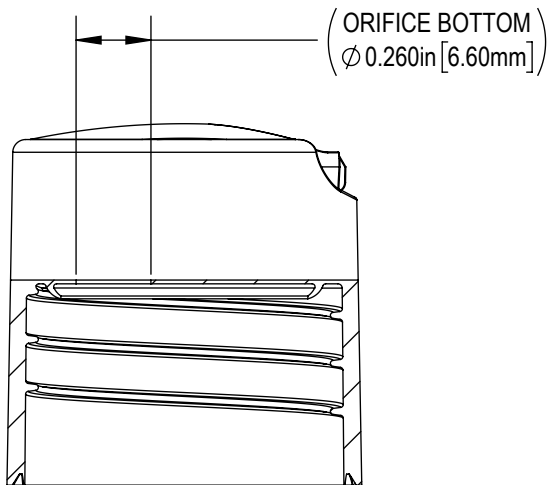
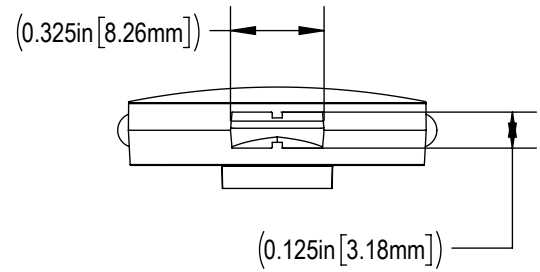
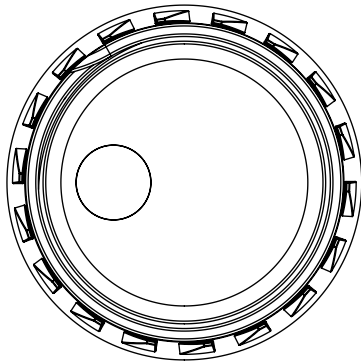

DISCLAIMER

THIS INFORMATION IS PROVIDED AS A GENERAL GUIDE, INCLUDING DIMENSIONS. IT IS THE CUSTOMER'S RESPONSIBILITIES TO SELECT THE PROPER CONTAINER FOR PRODUCT AND APPLICATION COMPATIBILITY.

DISTRIBUTED BY:



REF NO.:

DWG31213

DESCRIPTION:

28-410 Silver PP Domed Gloss Disc Top, No Liner .330 Orifice