

<b>Description</b>	55 Gallon Steel Tight Head Drum
<b>Material</b>	
Head	1.1 mm
Body	0.9 mm
Bottom	1.1 mm
<b>UN Number</b>	1A1/X1.8/300
<b>Exterior Finish</b>	
Top	BLACK
Top Panel	BLACK
Middle Panel	BLACK
Bottom Panel	BLACK
Bottom	RECYCLED GRAY
<b>Lining</b>	N/A
<b>Fittings</b>	3/4" -2" PLATED BUNA FLANGES; 3/4"-2" PLATED EPDM PLUGS
<b>Gaskets</b>	NONE
<b>Hoop</b>	2 "W"

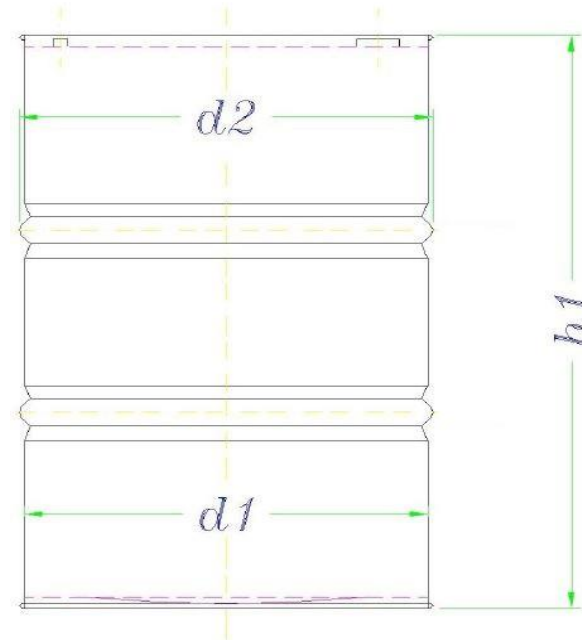

Dimensions	Measurements	Tolerances
h1	34.449 in	+ .125 / - .125
d1	22.5 in	+ / - 0.0
d2	23.425 in	+ / - 0.0
<b>Dimensions of Material</b>		
steel thickness of top	1.1 mm	
steel thickness of body	0.9 mm	
steel thickness of bottom	1.1 mm	
<b>Capacity</b>		
nominal volume	55 gal	
gross volume	57.2 gal	
<b>Weight</b>		
total	35 LBS.	+2 lbs / -2 lbs

**DISCLAIMER**

THIS INFORMATION IS PROVIDED AS A GENERAL GUIDE, INCLUDING DIMENSIONS. IT IS THE CUSTOMER'S RESPONSIBILITIES TO SELECT THE PROPER CONTAINER FOR PRODUCT AND APPLICATION COMPATIBILITY.

DISTRIBUTED BY:



REF NO.:

DWG30192

DESCRIPTION:

55 Gallon Black Unlined Steel TH Drum with 2" and 3/4" Tri-Sure Fittings